

## Project

# CINETIQUE AND LÉONA PLATEL SCHOOL

**atelierchora**  
émeric marchal architectes

## Architects

ATELIER CHORA

## Address

Rue de la Croix Rouge, 4000 Liège

Thier des Critchons 18  
4032 Chênée (Liège)

## Programme

Care center, classrooms, dining hall, kitchens, gym, locker rooms, physical therapy area, playrooms, offices, meeting rooms, multi-purpose rooms, common areas, storage, technical rooms, sanitary facilities, playgrounds, courtyard, surroundings

Tél : +32 42 22 21 32

info@atelier-chora.be  
<http://www.atelier-chora.be>

## About

The volumetry is mainly on one level that is organized around a central patio. This is to facilitate the mobility of the children, to conceal the school in the park and to provide a sense of protection for the children.

On the east side, three "inhabited" levels and a technical level punctuate the overall landscape as a counterpoint to the chapel located at the other end of the park. At the corner of rue Rassenfosse and the new alley, the volume hosts the physiotherapy space which constitutes a lantern, a landmark in the neighborhood for passers-by and streetcar users.

The main entrance is clearly identifiable in the street façade. The openings offer a view of the city and animate the façade along the traffic.

As soon as you pass through the door, the perspective opens up towards the interior courtyard. This perspective continues through the gym and towards the park. The kindergarten classes are oriented towards the south and the courtyard. It is a peaceful, reassuring and stimulating place: the vegetation and the interior courtyard encourage the curiosity and the awakening of all.

Translated with [www.DeepL.com/Translator](http://www.DeepL.com/Translator) (free version)

## OTHER PROJECTS :

Castle of Chevetogne  
- 2010 2016  
- Chevetogne

Reception building of the Liège University  
- 2016  
- Liège

School in Noiseux  
- 2011 2016  
- Somme-Leuze

House in Remicourt  
- 2012 2015  
- Remicourt

## Typology

Education

## Status

Built

## Conception

2018

## Delivery

2021

## Client

ISoSL

## Total budget

9 378 561,33

## Per square meters

/

## Area

3 626



View from the patio  
Â© Alain Janssens



View from the first floor  
Â© Alain Janssens



View from the park  
Â© Alain Janssens

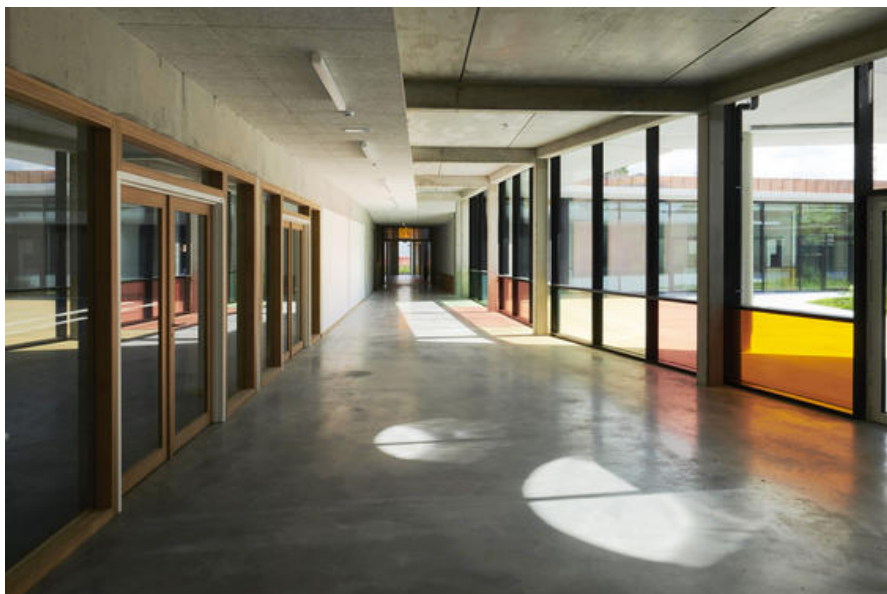

View from the circulation  
Â© Alain Janssens

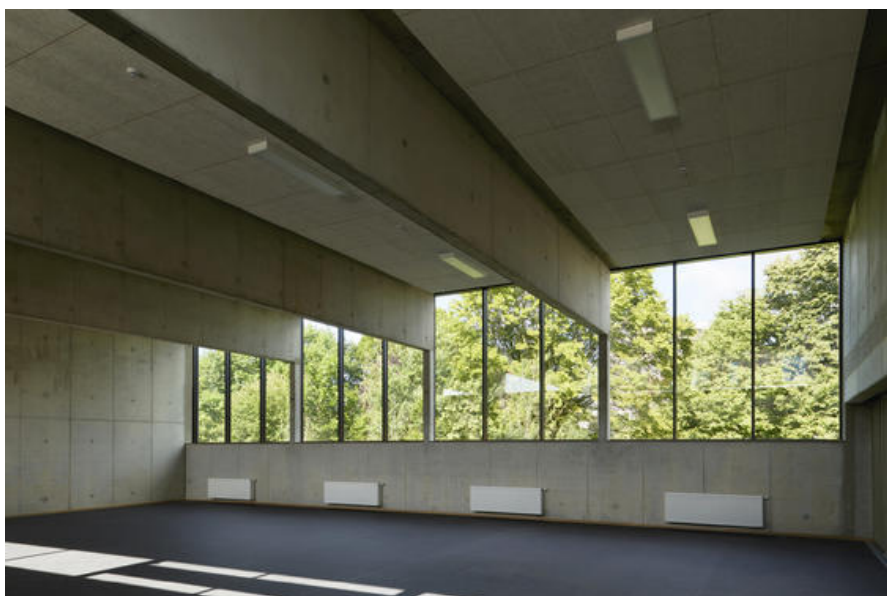

View from the gym  
Â© Alain Janssens