

Project

EXTENSION OF MACORS OFFICES

Rue de Libersart 1B
1457 Tourinnes-Saint-Lambert

Architects

LRARCHITECTES

Tél : 010/45 39 83

Address

Chaussée de Liège 31, 5360 Hamois

pra@lrarchitectes.com
www.lrarchitectes.com

Programme

Macors office extension: construction of 4 landscaped offices and a multi-purpose hall to meet the new needs of the company. It was designed as an extension of the existing offices. This extension is realised through a glazed walkway which is formally assimilated to the existing junction between the two existing buildings.

OTHER PROJECTS :

About

The project is located at the entrance to the village of Hamois along the Chaussée de Liège. The objective is to develop the Macors company in terms of internal management. The office extension has an entrance façade on the Rue d'Emptinne side. The newly created space, protected from the wind, becomes an outdoor multipurpose area where employees and workers can meet. The office complex consisted of two buildings: a building built before the 1970s with grey plastered walls and a slate roof, and a building built in 2000 with natural concrete walls and anodised aluminium corrugated sheets with a flat roof. The new building has its own identity. The architecture developed reflects the company's image, simple and efficient. The facades towards the park and towards Rue d'Emptinne are completely glazed. This transparency formalises the identity of the extension. The "tripled volumes" are united by a 50m long circulation space. Four landscaped offices and a reception room are integrated into the project. The reception room on the ground floor is linked to the park and the two terraces. The offices on the park side so that all employees can enjoy the bucolic atmosphere of the place. The simplicity of the plan extends to the construction. The two closed facades take up the weight of the building. Concrete is used, reflecting the structure but also the know-how of the construction company.

House LV
- 2006 2008
- Seneffe

House VG
- 2006 2010
- Thieusies

House BA
- 2007 2010
- Durnal

Housing Arsenal
- 2007 2018
- Pont-à-celles

Typology

Offices (include mixed use)

Status

Built

Conception

2016

Delivery

2020

Client

Macors s.a.

Area

423

Stability

Bureau Delvaux

Landscape

Atelier Paysage

Others CO2 Challenge (PEB)

Others DL COnsult (CSS)

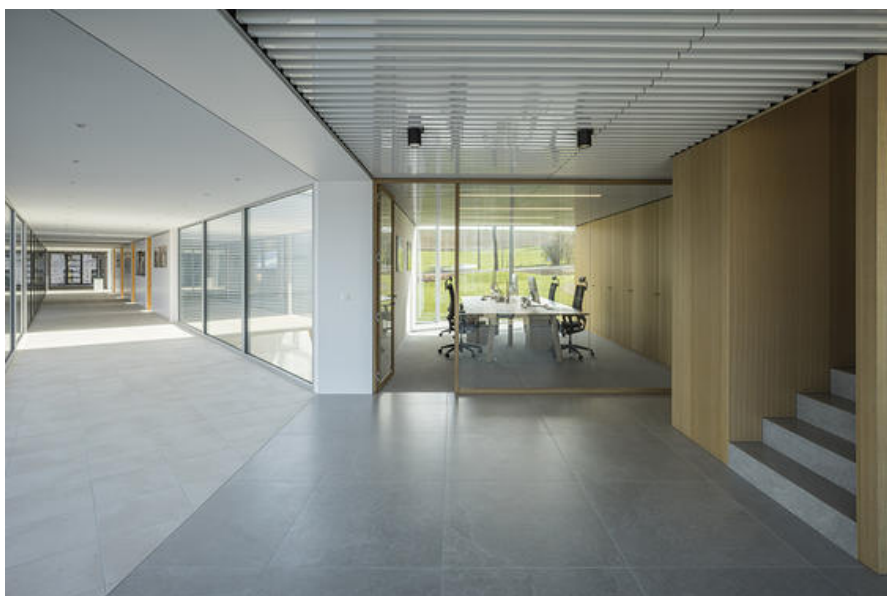

Â© Vermeulen Maxime



Â© Vermeulen Maxime



Â© Vermeulen Maxime



Â© Vermeulen Maxime



Â© Vermeulen Maxime