

Project

NOTRE DAME DE LA PAIX COLLEGE

Rue de Libersart 1B
1457 Tourinnes-Saint-Lambert

Architects

LRARCHITECTES

Tél : 010/45 39 83

Address

Place Notre-Dame de la Paix, 5, 5101 Erpent

pra@lrarchitectes.com
www.lrarchitectes.com

Programme

The Collège Notre-Dame de la Paix is a school campus located in a green and open environment where children from kindergarten to secondary school are taught. Creation of a kindergarten with 200 pupils in close connection with the primary section. Extension of the secondary section. Creation of a sports field with its specific service premises. Redevelopment of the playgrounds and play areas of the primary section and the access to the secondary section.

OTHER PROJECTS :

House LV
- 2006 2008
- Seneffe

House VG
- 2006 2010
- Thieusies

House BA
- 2007 2010
- Durnal

Housing Arsenal
- 2007 2018
- Pont-à-celles

About

The Collège Notre-Dame de la Paix is a school campus located in a park where children from kindergarten to secondary school are taught. The new buildings have their classrooms organised around generous and luminous common spaces offering transversal views between the spaces and on the landscape.

The aim was to extend the secondary education section, create a new kindergarten and create a second sports hall while preserving the spirit of the original school campus. Each of the three buildings is designed on a square plan to ensure compactness. The structure of each building is rational, simple and efficient.

The interior spatial organisation of the secondary section places the classrooms around generous and luminous common centres so that formal and informal meetings are encouraged between users (teachers, educators, students and administrators) allowing group work in line with the pedagogy developed by the school. The spatial organisation of the nursery school provides for interconnected classrooms on the periphery of the building and common areas for play and sharing in the heart of the building. All the spaces are intended to be modular and adaptable according to circumstances, group sizes and the educational tasks to be carried out.

The project was carried out in two phases: Phase 1: nursery and secondary schools - Phase 2: sports hall

Typology

Education

Status

Built

Conception

2013

Delivery

2021

Client

Collège Notre-Dame de la Paix asbl

Total budget

4.706.924,34

Per square meters

1340

Area

3512

Stability	Bureau Delvaux
Special techniques	Escarmelle
Acoustic	Cedia
Others	Corepro (CSS)
Others	Home-consult (PEB)

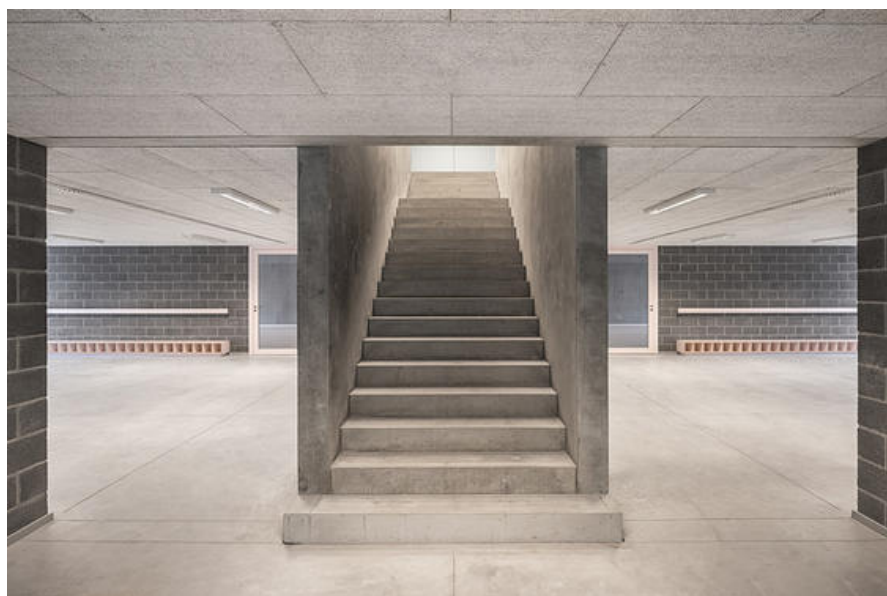

Â© Vermeulen Maxime

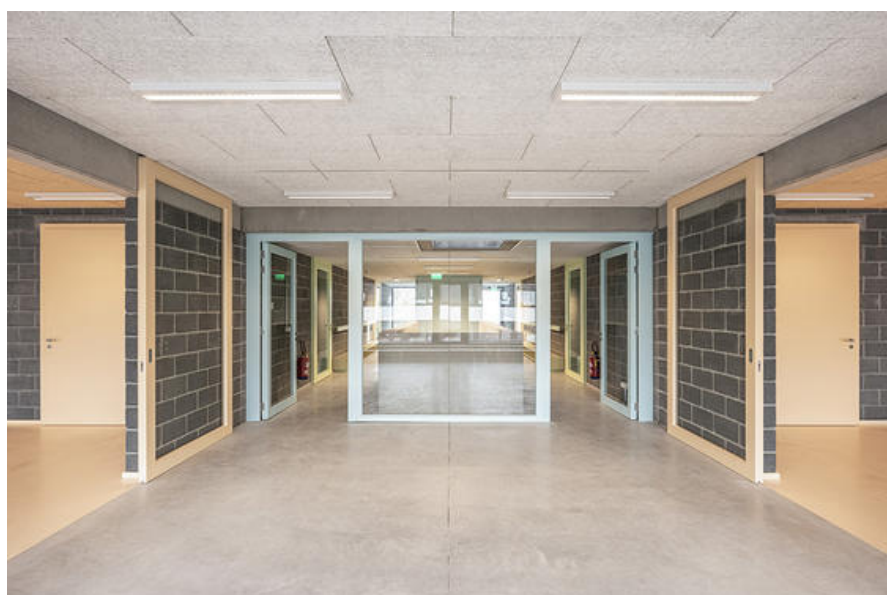

Â© Vermeulen Maxime



Â© Vermeulen Maxime



Â© Vermeulen Maxime



Â© Vermeulen Maxime