

Project

# CYGNES-DIGUE: HOUSING AND PUBLIC FACILITIES

rue de Lisbonne 22  
1060 Bruxelles

Architects

LEDROIT PIERRET POLET ARCHITECTES

Tél : 32 2 513 09 58

Address

rue des Cygnes et rue de la Digue, 1050 Bruxelles

info@lpparchitectes.be  
<http://www.lpparchitectes.be>

Programme

Public building and social housing (24kWh/m2year)

## OTHER PROJECTS :

Typology

Civic and community

Status

Built

Inside-Outside private house

- 2005 2007

- Bruxelles (Molenbeek-Saint-Jean)

Conception

2005

Delivery

2014

Private house Nuit blanche

- 2004 2008

- Bruxelles

Client

Commune d'Ixelles et Beliris

Nurcery + multiple-unit residential housing

- 2009 2012

- Saint-Gilles

Total budget

5 114 183

Area

4 600

Architects

Atelier de l'Arbre d'Or; Label architecture

Urban planning

- 2010 2011

- Saint-Gilles

Stability

Bureau d'études Greisch

Special techniques

Bureau d'études Greisch

Landscape

Territoires



À© Tim Van de Velde



Â© Tim Van de Velde

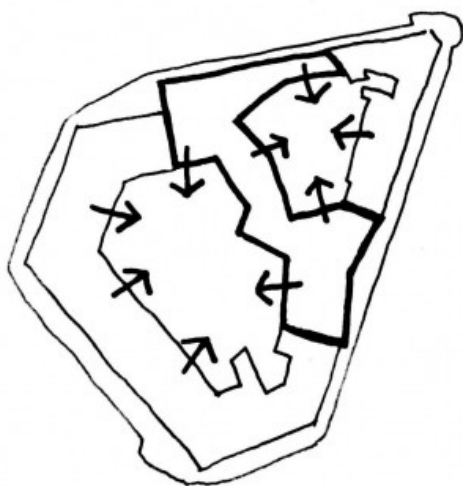

Â© Vincent Pierret

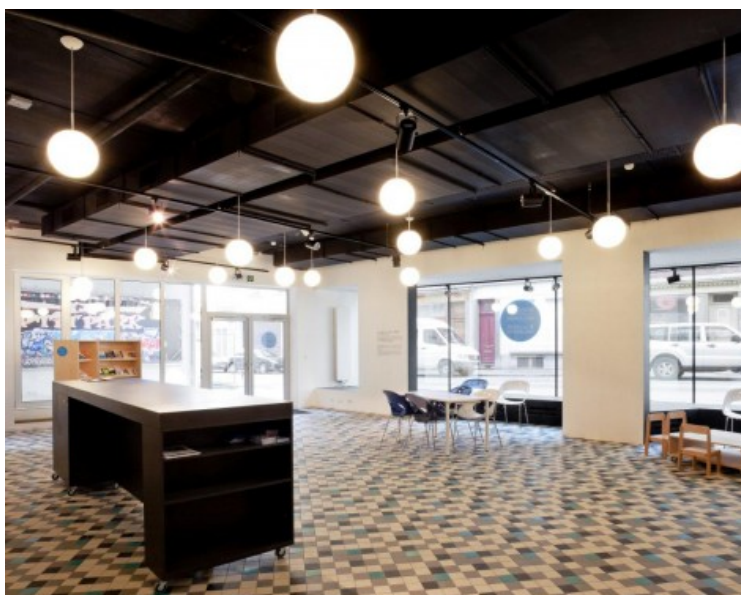

Â© Tim Van de Velde



Â© Tim Van de Velde