

Project

BAMBINO CANTEEN

Architects

NAÏF ARCHITECTURE

Albine@naif.brussels

Address

Avenue Louise 231, 1050 Bruxelles

OTHER PROJECTS :

Programme

From company restaurant to restaurant concept for building or neighborhood.

Karreberg
- 2016 2018
- Hoeilaart

About

Changing eating habits of not just a company, but of an entire building? That's the story of Bambino Canteen. A kitchen concept with a focus on fresh, local, and seasonal food. Breakfast, take-out or after works, group meetings or tête-à-têtes, in this hybrid space Bambino serves it any time of the day. Combining functionality and advanced aesthetic research, in each of its locations Naïf have allowed Bambino to unfold a little extra soul that makes all the difference?

Silversquare Central
- 2021 2022
- Bruxelles

Silversquare Bailli
- 2019 2020
- Ixelles

Typology

Hotels, restaurants, bars

Ecole de la Scene
- 2022 2022
- Uccle

Status

Built

Conception

2020

Delivery

2020

Client

Bambino



À© Jules Cesure



© Naif Architecture

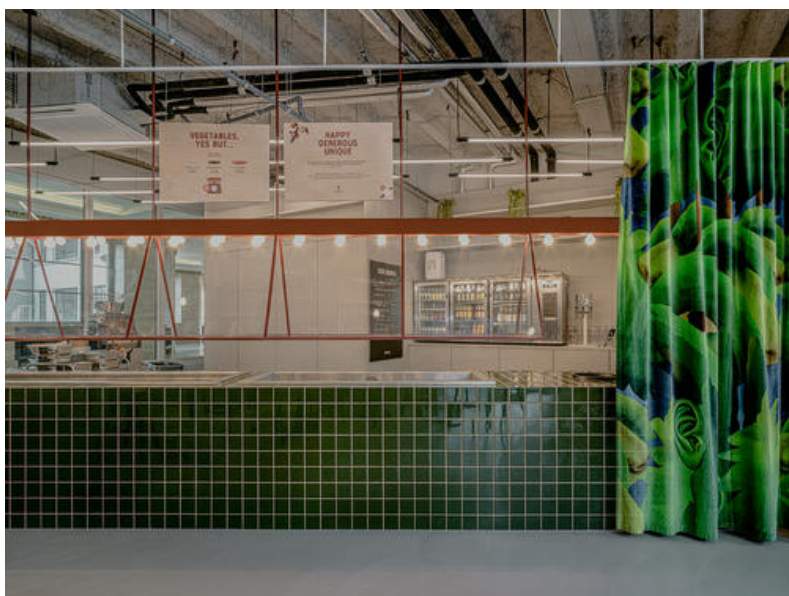

© Jeroen Verecht



© Marthe Hoet